

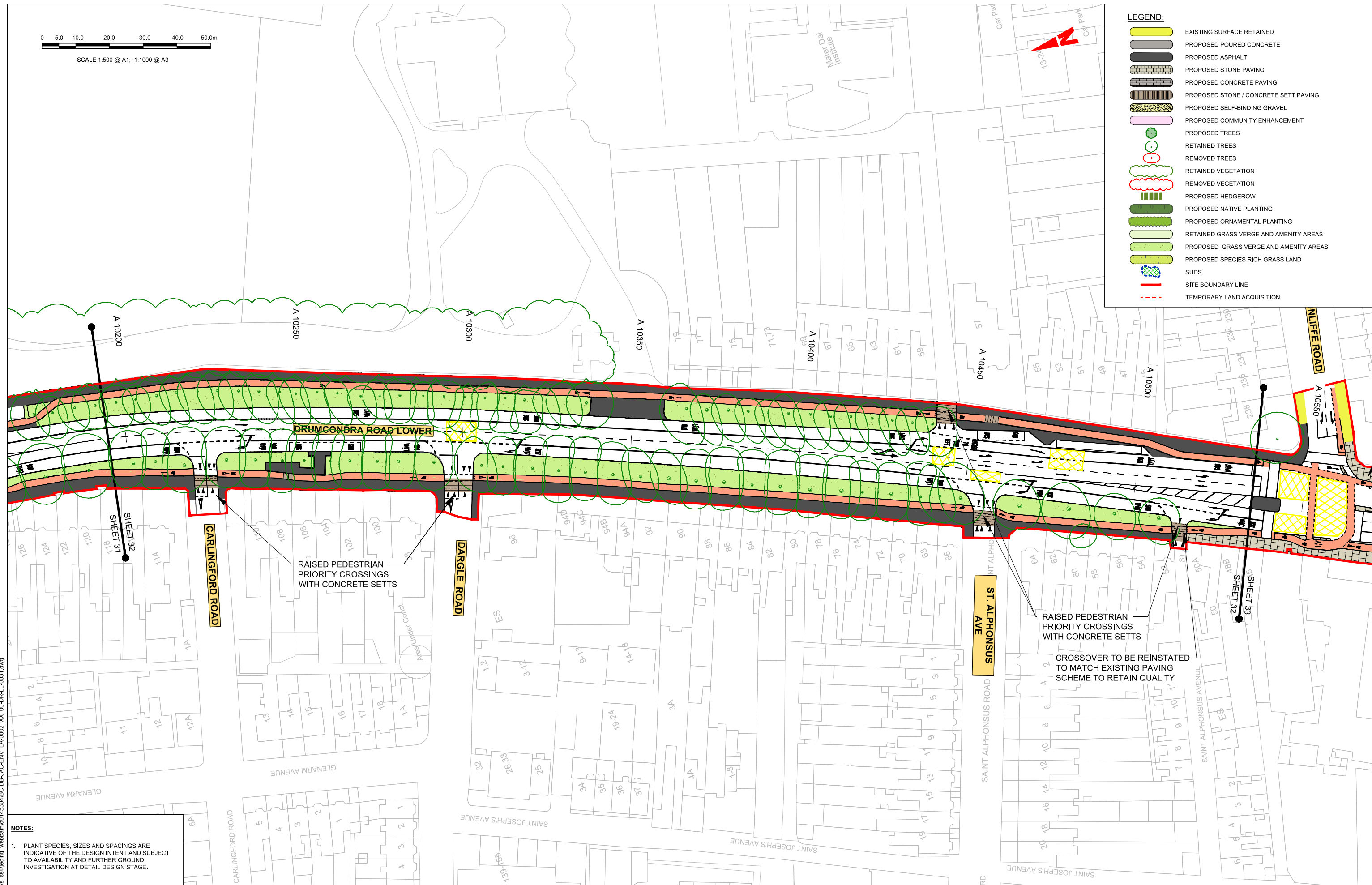

SCALE 1:500 @ A1; 1:1000 @ A3

LEGEND:

	EXISTING SURFACE RETAINED
	PROPOSED POURED CONCRETE
	PROPOSED ASPHALT
	PROPOSED STONE PAVING
	PROPOSED CONCRETE PAVING
	PROPOSED STONE / CONCRETE SETT PAVING
	PROPOSED SELF-BINDING GRAVEL
	PROPOSED COMMUNITY ENHANCEMENT
	PROPOSED TREES
	RETAINED TREES
	REMOVED TREES
	RETAINED VEGETATION
	REMOVED VEGETATION
	PROPOSED HEDGEROW
	PROPOSED NATIVE PLANTING
	PROPOSED ORNAMENTAL PLANTING
	RETAINED GRASS VERGE AND AMENITY AREAS
	PROPOSED GRASS VERGE AND AMENITY AREAS
	PROPOSED SPECIES RICH GRASS LAND
	SUDS
	SITE BOUNDARY LINE
	TEMPORARY LAND ACQUISITION



- NOTES:**
- PLANT SPECIES, SIZES AND SPACINGS ARE INDICATIVE OF THE DESIGN INTENT AND SUBJECT TO AVAILABILITY AND FURTHER GROUND INVESTIGATION AT DETAIL DESIGN STAGE.

Disclaimer
 © National Transport Authority (NTA) 2022. This drawing is confidential and the copyright in it is owned by NTA. This drawing must not be either loaned, copied or otherwise reproduced in whole or in part or used for any purpose without the prior permission of NTA.
 This drawing is to be used for the design element identified in the titlebox. Other information shown is to be considered indicative only. The drawing is to be read in conjunction with all other relevant design drawings.
 O.S. data used for plans are printed under © Ordnance Survey Ireland Government of Ireland. All rights reserved. Licence Number 2022/OSI/NMA_160 National Transport Authority. All elevations are in metres and relate to OSI Geoid Model (OSGM15) Malin Head. All Co-ordinates are in Irish Transverse Mercator Grid (ITM) as defined by OSI active local GPS station.
 Information concerning the position of apparatus shown on this drawing is based on drawings supplied by the utility owners and/or the utility works contractor, whilst every care has been taken in the preparation of this drawing, positions should be taken as approximate and are intended for general guidance only and no representation is made by the NTA as to the accuracy, completeness, sufficiency or otherwise of this drawing and the position of the apparatus. The information contained herein does not purport to be comprehensive or final as the apparatus is subject to being altered and/or superseded. Recipients should not rely on this information. Any liabilities are hereby expressly disclaimed.

The information contained herein has been provided by the NTA but does not purport to be comprehensive or final. Recipients should not rely on the information. Neither the NTA nor any of its directors, officers, employees, agents, stakeholders or advisers make any representation or warranty as to, or accept any liability or responsibility in relation to, the adequacy, accuracy, reasonableness or completeness of the information provided as part of this document or any matter on which the information is based (including but not limited to loss or damage arising as a result of reliance by recipients on the information or any part of it). Any liabilities are hereby expressly disclaimed.



Rev	Date	Drn	Chk'd	App'd	Description
M01	06/04/2023	ACW	IL	HOS	ISSUE FOR PHASE 4: PLANNING

Client: **NTA**
 Údarás Náisiúnta Iompair
 National Transport Authority

Engineering Designer: **Jacobs**

Date	Scale	Drawn	Checked	Approved
06/04/2023	1:500 @ A1 1:1000 @ A3	ACW	IL	HOS
Project Code	Originator Code	QMS Code		
BCIDB	JAC			

Programme Title BUSCONNECTS DUBLIN CORE BUS CORRIDORS INFRASTRUCTURE WORKS			
Drawing Title SWORDS TO CITY CENTRE CORE BUS CORRIDOR SCHEME LANDSCAPING DESIGN			
Drawing File Name BCIDB-JAC-ENV_LA_-0002_XX_00-DR-LL-0032	Sheet Number 32 of 37	Status A	Rev M01

DO NOT SCALE USE FIGURED DIMENSIONS ONLY